

## INSTALLATION INSTRUCTIONS

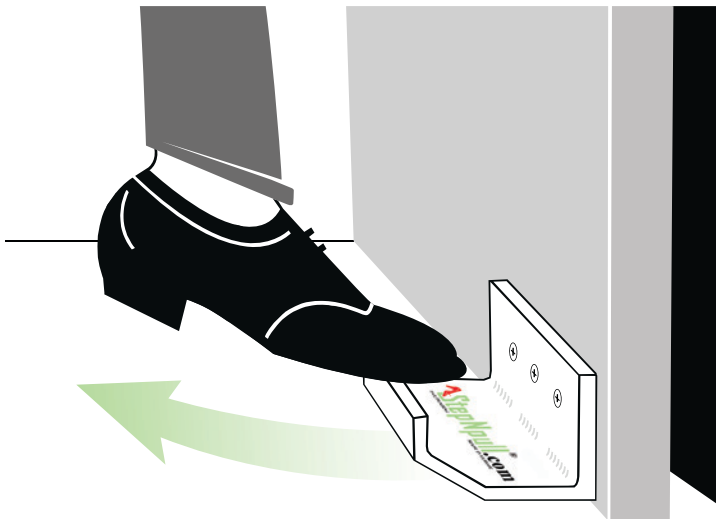

**Important!** StepNpull<sup>®</sup> will work great on any commercial solid core wood door or commercial metal door regardless of the door's size or weight. If, however, the door is abnormally difficult to pull open, the door closer resistance should be decreased.

**Attention!** Before installing StepNpull<sup>®</sup>, check for wall interference when door is fully open. The StepNpull<sup>®</sup> bracket has two rubber bumpers designed to contact the wall if wall interference is a concern.

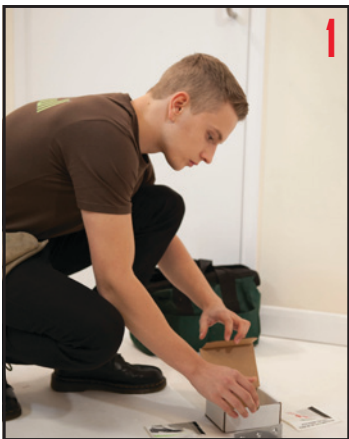

StepNpull® should be mounted approximately 4mm from the bottom of the door and approximately 4mm from the edge of the door.



Mark the holes with a pencil while holding the StepNpull® against the door in the appropriate level mounting position. If a metal kick plate is on the door, drill 6mm holes, where marked for the bracket, through the metal plate before going to the next step (only go through the metal and be careful not to drill into the door).



**Solid wood doors:** Once the holes are marked use one of the screws supplied to create a pilot hole, for each of the three holes, by screwing it in about 6mm deep and then removing. Alternately, a 4mm drill bit may be used instead to make the 6mm deep pilot holes. Although not required, it is highly recommended that you use the sexed bolt provided in the middle hole per the directions listed in the next section “Metal doors”.

**3b**

**Metal doors:** Drill a pilot hole for each of the three holes using a 5mm bit. A sexed bolt should be used in the middle hole and 30mm long screws in the outer two holes. To prepare the centre hole for the sexed bolt, use a 8mm bit to enlarge the centre hole and then continue drilling through the outer metal skin (be sure to keep the drill bit perpendicular to the door while drilling the outer hole). Remove any burrs. Loctite thread locker should be used on the bolt threads.

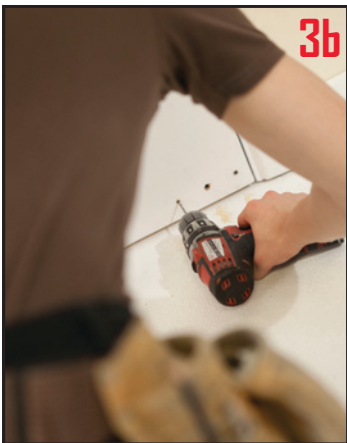
**4****5**

Hold the StepNpull® against the door and install the centre screw/bolt but don't tighten it completely. Install the two outer screws. Tighten the centre screw and then double check the outer screws. To avoid stripping the screw head, use a large #2 or #3 Phillip's screwdriver or bit.



Open the door fully and check for any interference issues with the wall or floor mounted door stop.



Install the instructional sign just above the door handle. Install second sign on mirror, paper towel dispenser or hand dryer.



Installation complete. You're now just one step away from a clean exit!

# “DEMAND IT”

## Hands Free Door Opener

# stepnpull.com

Fitting instructions are for guidelines use only. This product should be fitted by an approved / affiliated **StepNpull**<sup>®</sup> agent to maintain all product liabilities, regulations & warranties.